

2DP1L0EFA

Installation instructions for 2 button remote control kits for use in dump trailer or power up dump gravity down or similar applications. 1 BUTTON HAS DUAL FUNCTION (Double Pull) THE SECOND BUTTON IS A SINGLE FUNCTION

Remote Function- **SEE Figure 1** When the (A) button is pressed on the remote power is sent to the blue wire and the gray wire until the button is released. When the (B) button is pressed power is sent to the white wire only.

We have programmed the keychain remote to your base unit for you. If you need to reprogram see page 3

No more than 14 amps total at any given time can run through the receiver. We recommend the use of 10 amp diodes on the control wires to prevent any power feedback into the receiver. For higher amp uses you must use relays... with the unit. It is recommended to wire in a on off switch on the power (red wire) of the receiver to prevent battery drainage when the unit is not in use.

THESE INSTRUCTIONS ARE FOR WIRING POWER UP GRAVITY DOWN APPLICATIONS (i.e. dump trailers that need to power a motor and open a valve to go up and to only open a valve to go down without activating a motor.

What you need:

12vdc test light

wire connectors (varies depending on application) and or scotch locks. **NOTE: use dielectric grease on all splice connections to prevent corrosion.**

Wire stripper / crimper

This kit contains the following:

1- 2 button keychain remote

1- wireless base unit box with pigtails

1. Mount unit (base unit with wiring pigtails) near equipment motor.
2. Run a 14 gauge wire from a 12vdc battery or keyed ignition power to red terminal
3. Connect the black wire from the base unit to the battery ground or a good ground.
4. Connect the gray wire from the base unit to the small terminal that activates the solenoid that controls (OR SENDS POWER TO) the motor.
5. Connect the white wire (which is activated with button (B) see figure1) to the hot side of the lower valve wire (you can find this wire on your equipment by activating the function and the probing the wire with a test light)
6. Connect the blue wire (which is activated with the button (A) see figure 1) to the hot side of the raise valve wire.
9. Test toggle switch and remote functions. Your control is now ready for use.
10. **MAKE SURE YOU HAVE SECURE AND CLEAN CONNECTIONS EVERYWHERE**

FIGURE 1

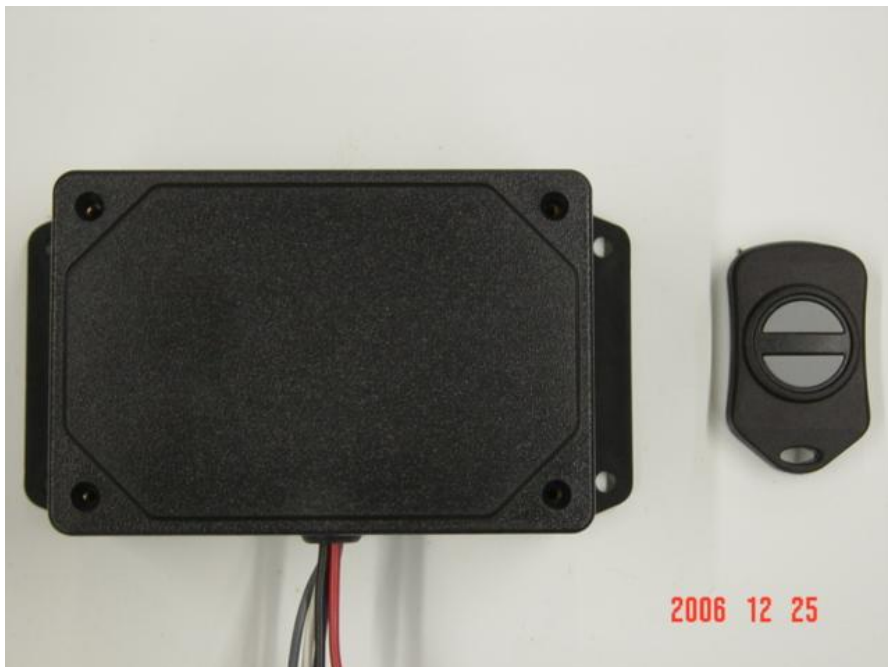
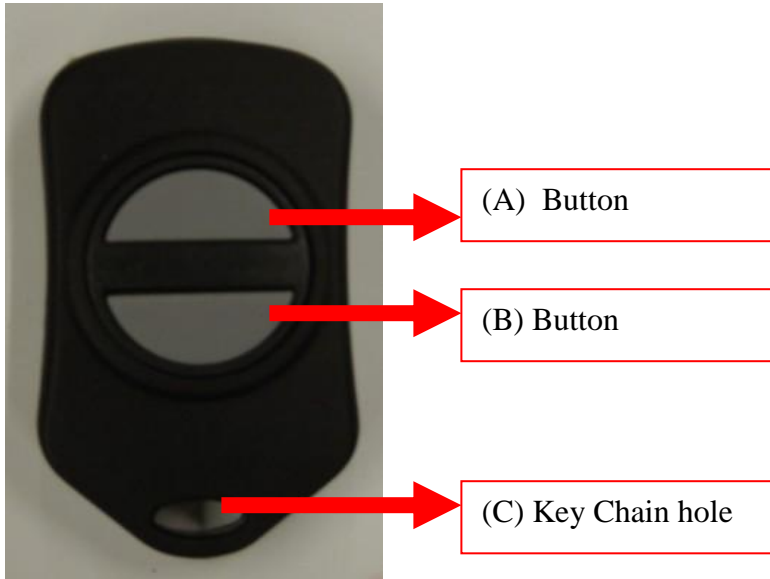

SETUP KEYCHAIN REMOTE TO BASE UNIT ADDRESS

Your keychain remote was setup to your receiver at the factory. If you need to reprogram your existing remote or are adding or replacing one follow the instructions below.

Please follow these steps:

1. Power up the base unit and remove the cover of the base unit with a small Phillips screw driver.
2. On the back side of the keychain remote depress the ADD button with a paperclip and release. (If working properly a blue light in the window will blink).
3. Flip the keychain remote over and push each button individually to send address to the base unit.
THEN WAIT UNTIL THE BLUE LIGHT STOPS BLINKING AND PROCEED.
4. Go to the base unit and push the black button. The red LED will begin to flash.
5. Again push each button on the keychain remote to save the unique address (1 in 16 million)
6. Push black button on the base unit to end the programming mode and the red LED will stop flashing.
YOUR UNIT IS NOW READY TO USE.

BATTERY REPLACEMENT

The Keychain remote uses a standard CR2032 Lithium button cell battery. In normal use it will provide 1-2 years of operation. To replace the battery, gently pry apart the 2 halves of the remote.

Remove the battery by sliding it out from underneath the retainer. Observe the battery polarity when replacing. Once the battery is replaced, **YOU NEED TO REPROGRAM THE KEYCHAIN TO THE BASE UNIT**